

## ONE PERSON BRAKE AND CLUTCH BLEEDER KIT

### User Manual



## General Information

**Thank you** for purchasing a Blue Spot Tools product, you can find further information on our range at **[www.BlueSpot.uk.com](http://www.BlueSpot.uk.com)**. Please ensure that you are using the product correctly and that all guidance and cautions are followed in accordance with the instructions. Please retain these instructions for future reference.

## Safe use

Please make sure that you read these instructions carefully in order to avoid injury when using the brake and clutch bleeder kit. Follow all health and safety rules and regulations. If in doubt and available please contact a more knowledgeable source.

### **DO NOT use if damaged.**

- **ALWAYS** ensure you have read through all of the instructions and fully understand how to operate the tool before beginning.
- **ALWAYS** check the brake and clutch bleeder kit for any damage before use. Any damage found needs to be repaired or replaced before use to prevent damage to property or personal injury.
- **ALWAYS** dress appropriately – clothing should be close fitted and long hair tied back. Jewellery should be removed and shoes should be worn with a non-slip sole.
- **ALWAYS** wear the correct PPE equipment. Approved eye protection should always be worn. If brake fluid enters the eyes make sure they are rinsed immediately with plenty of water and seek medical advice. If brake fluid is swallowed seek medical advice immediately.
- **ALWAYS** ensure you work in a well ventilated room.
- **ALWAYS** check for missing or damaged parts before use.
- **ALWAYS** check the vehicle for broken or damaged parts that could impact on the tools operation.
- **ALWAYS** ensure you feel comfortable and confident in knowing what you are doing with the brake components and brake lines. If you feel unsure or have questions please seek professional advice.
- **ALWAYS** refer to the manufacturers instructions when lifting, removing wheels or disassembling the braking system.
- **ALWAYS** refer to the manufactures instructions when reassembling the braking system or wheels.

## Safe use (continued)

- **BE AWARE** that only new brake fluid should be used. If used brake fluid is used this will cause damage to the system and possible brake system failure could occur.
- **BE AWARE** that brake fluid is flammable. Always keep brake fluid away from sources of ignition, including hot surfaces.
- **BE AWARE** that brake fluid can damage paintwork. If any brake fluid is spilled it should be flushed with water immediately.
- Maintain tool in good and clean condition for best and safest performance.
- Keep the work area clean, uncluttered and ensure there is adequate lighting.
- Maintain correct balance and footing. Ensure the floor is not slippery and wear non-slip shoes.
- Keep children and unauthorised persons away from the work area.
- **ALWAYS** store the brake and clutch bleeder kit away correctly when not in use.
- **ALWAYS** ensure waste liquids have been disposed of correctly and in accordance with local authority regulations.
- **DO NOT** allow untrained persons to use the kit.
- **DO NOT** operate the tool if you are tired as this could be dangerous.
- **NEVER** operate the tool if you are under the influence of drugs or alcohol as this is dangerous.
- **DO NOT** make modifications to the brake and clutch bleeder kit.
- **NEVER** use the brake and clutch bleeder kit to perform a task it was not designed to do.
- **ALWAYS** stop using the tool straight away if you start to experience discomfort or pain. Consult with a qualified health professional if needed.
- If the brake and clutch bleeder kit is damaged do not use.

## Introduction

The Blue Spot Tools One Person Brake And Clutch Bleeder Kit enables the user to extract and replace brake fluid at the same time, using the air pressure from your spare tyre (max 20PSI - 10PSI for older systems).

The kit comes complete with a 500ml container with a magnetic base which keeps it in situ during use as well as brake bleed tubes of various sizes and a range of common sized reservoir caps suitable for most vehicle types.

- Ideal for brake bleeding or full replacement of fluid in the system
- Suitable for most vehicle types

## Introduction (continued)

- One handed use
- Reservoir cap sizes 25, 27, 44/45, 46mm
- Magnetic container

**Contents** - 1 x bottle (pressurised for new brake fluid), 1 x bottle cap, 2M black air hose with pressure valve, 70cm transparent tank connection tube with replacement tube, 20cm transparent drain tube with replacement tube, 1 x 25mm cap and seal for lockhead systems, 1 x 27mm cap and seal for VAG systems, 1 x 44/45mm cap and 2 seals for girling metal tanks and all ATE systems and 1 x 46mm cap and seal for some girling systems.

### Pressure Regulator

### Air Line

### Tyre connector

### Adaptor Cap



## Specification

Maximum air supply – 20PSI

## Operation

Before beginning always ensure you have read the safe use points from the manual and that they have all been followed.

**ALWAYS** ensure you have familiarised yourself with the hazards of brake fluid before beginning.

### **Brake Bleeding Procedure**

**ALWAYS** ensure you have checked the brake and clutch bleeder for any damage before operation. If any damage is found it needs to be repaired or replaced before beginning.

Refer to the vehicle manufacturers instructions for brake bleeding and for the wheel sequence. Familiarise yourself with the instructions and follow the steps they set out on how this should be done.

If the vehicle manufacturer does not have these specific instructions please follow the steps below –

**ALWAYS** ensure that the vehicle brakes have been adjusted before proceeding with bleeding the brakes.

If the vehicle is fitted with servo assisted brakes the engine will need to be switched off and then the brake pedal will need pumping two or three times. This will remove the air from the servo.

1. On the vehicles brake master cylinder the reservoir cap will need to be removed.
2. Find the best suited adaptor cap and fit to the automatic brake bleeder.
3. Connect the brake bleeder to the master cylinder.
4. The tyre pressure on one of the vehicle tyres will need to be adjusted or a spare wheel used to a maximum of 20 PSI.
5. Connect the automatic brake bleeder.
6. To ensure the bottle has no leaks or damage perform a pressure test with no brake fluid.
7. When complete release the pressure and disconnect from the tyre.
8. With new clean brake fluid fill the pressure bottle.

**ALWAYS** check that the cap is correctly sealed on the pressure bottle.

**BE AWARE** not to overtighten the pressure bottle cap.

9. Make sure the regulator on the top of the bottle is in the closed position. Refer to the image on page 6 on how this should look.
10. Connect the air line to the tyre.

## Operation (continued)

11. Set the pressure bottle in an upright position.
12. Carefully open the regulator anti-clockwise to pressurise the brake system.
- BE AWARE** that 20 PSI is a recommendation and can be lowered. The regulator valve should be adjusted according to the vehicle being worked on.
13. With the bleed nipple that is furthest away from the master cylinder attach a bleed tube to it. The other end of the tube will need to be placed into a suitable container.
14. Allow the old brake fluid to flow into the container by loosening the bleed nipple. Refer to the image on page 6 on how this should look.
15. Re-tighten the brake nipple when the fluid is clean and free from air.
16. Refer back to the manufactures sequence and repeat the operation for the remaining brake nipples.
- DO NOT** allow the pressure bottle to run out of brake fluid. Close the regulator and disconnect the tyre if the brake fluid needs topping up.
17. Always ensure the tyre is disconnected before removing from the brake master cylinder when the brake bleeding is complete.
18. Top up the brake fluid in the reservoir to the maximum level and replace the original reservoir cap if needed.
19. Ensure the tyre has been re-pressurised to its normal operating pressure.

**ALWAYS** check the brakes on the vehicle when the brake bleeding is complete to make sure they are working correctly and are not spongy. The vehicle must not be used on the road until the brakes have been correctly tested.

### **Brake Systems with a Tandem Master Cylinder**

Brake Systems with A Tandem Master Cylinder require two lines to be bled at the same time. This is usually one front and one rear. To do this open both of the bleed nipples and control the flow by adjusting the regulator on the top of the pressure bottle.

### **Uncommon Brake Systems**

If the master outlet is below the inlet on the vehicle the brake pedal may need to be pumped once or twice in conjunction with the pressure bleed. The vehicle can also be jacked up to raise the outlet as an alternative.

### **Clutch Bleeding Procedure**

For the clutch bleeding procedure refer to the vehicle manufacturers instructions. Follow the instructions above for brake bleeding if the vehicle manufacturer does not have these instructions.

## Operation (continued)

### Regulator in the closed position

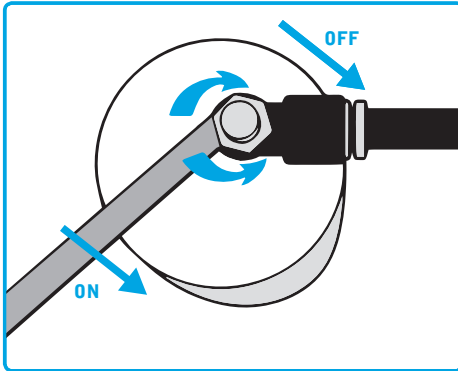

### Loosening the bleed nipple

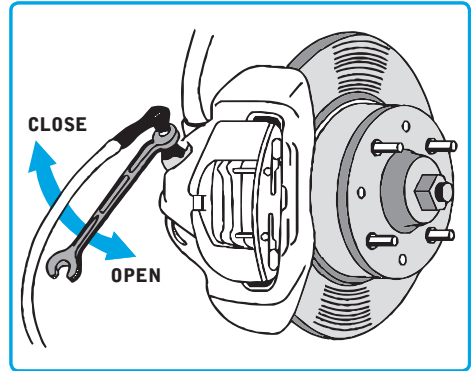

## Cleaning & Maintenance

**ALWAYS** ensure the brake and clutch bleeder kit has been de-pressurised before cleaning or performing any maintenance.

**ALWAYS** ensure the fluids have been drained from the pressure bottle and tubes.

Wipe down the brake and clutch bleeder kit with a clean cloth.

**BE AWARE** of any spilt brake fluid. This should be cleaned up with a clean cloth.

## Storage

**ALWAYS** ensure the brake and clutch bleeder kit is stored out of reach of children.

Store the tool in a secure, dry place.

## Disposal

Always check and adhere to national regulations when disposing of any tools that are no longer functional and cannot be repaired.

- Contact your local waste disposal authority for information on how to correctly dispose of tools.

## Environmental Protection

Recycle unwanted materials instead of disposing of them as waste. All tools, accessories and packaging should be sorted, taken to a recycling centre and disposed of in a manner which is compatible with the environment. When the product becomes completely unserviceable and requires disposal, drain any fluids (if applicable) into approved containers and dispose of the product and fluids according to local regulations.



## Contact

Find out more about Blue Spot Tools® products at [www.BlueSpot.uk.com](http://www.BlueSpot.uk.com)

Tel: 0800 093 0115

Email: [sales@bluespot.uk.com](mailto:sales@bluespot.uk.com)

Orme Business Centre,  
Greenacres Road,  
Oldham,  
OL4 3NS

## Notes

---

---

---

---

---

---

---

---